

United States Department of the Interior
National Park Service

For NPS use only

National Register of Historic Places
Inventory—Nomination Form

received

date entered

See instructions in How to Complete National Register Forms
Type all entries—complete applicable sections

1. Name

historic Parkis-Comstock Historic District, Amendment

and/or common

2. Location

street & number 568, 570-72 Broad Street and 39-41,
54-56, and 60-62 Harvard Avenue not for publication

city, town Providence N/A vicinity of

state Rhode Island code 44 county Providence code 007

3. Classification

Category	Ownership	Status	Present Use
<input checked="" type="checkbox"/> district	<input type="checkbox"/> public	<input checked="" type="checkbox"/> occupied	<input type="checkbox"/> agriculture
<input type="checkbox"/> building(s)	<input checked="" type="checkbox"/> private	<input checked="" type="checkbox"/> unoccupied	<input type="checkbox"/> commercial
<input type="checkbox"/> structure	<input type="checkbox"/> both	<input type="checkbox"/> work in progress	<input type="checkbox"/> educational
<input type="checkbox"/> site	Public Acquisition	Accessible	<input type="checkbox"/> entertainment
<input type="checkbox"/> object	N/A In process	<input checked="" type="checkbox"/> yes: restricted	<input type="checkbox"/> government
	<input type="checkbox"/> being considered	<input type="checkbox"/> yes: unrestricted	<input type="checkbox"/> industrial
		<input type="checkbox"/> no	<input type="checkbox"/> military
			<input type="checkbox"/> museum
			<input type="checkbox"/> park
			<input checked="" type="checkbox"/> private residence
			<input type="checkbox"/> religious
			<input type="checkbox"/> scientific
			<input type="checkbox"/> transportation
			<input checked="" type="checkbox"/> other: vacant

4. Owner of Property

name Owners' list on file at R.I.H.P.C.

street & number

city, town vicinity of state

5. Location of Legal Description

courthouse, registry of deeds, etc. Providence City Hall

street & number Dorrance Street

city, town Providence state Rhode Island 02903

6. Representation in Existing Surveys

title Elmwood, P-P-3, Statewide Preservation
Report (See Cont. Sheet #1) has this property been determined eligible? yes no

date 1979 federal state county local

depository for survey records R.I. Historical Preservation Commission

city, town Providence state Rhode Island 02903

7. Description

Condition		Check one	Check one
<input type="checkbox"/> excellent	<input checked="" type="checkbox"/> deteriorated	<input type="checkbox"/> unaltered	<input checked="" type="checkbox"/> original site
<input type="checkbox"/> good	<input checked="" type="checkbox"/> ruins	<input checked="" type="checkbox"/> altered	<input type="checkbox"/> moved date _____
<input checked="" type="checkbox"/> fair	<input type="checkbox"/> unexposed		

Describe the present and original (if known) physical appearance

This proposed amendment to the Parkis-Comstock Historic District is located immediately south of the eastern Comstock Street section of the current district and consists of five houses and one carriage house along Harvard Avenue at Broad Street. These properties are contemporary with those already included and like their counterparts, are ample and stylish Late Victorian dwellings.

INVENTORY OF STRUCTURES

BROAD STREET

- NC-568 Store (c. 1950): A 1-story, flat-roofed masonry structure with two glass-and-aluminum storefronts.
- 570 Charles Atwood House (1897): A 2½-story, Queen Anne house with a semi-octagonal corner tower and a broad Colonial Revival veranda and Colonial Revival architectural detailing. The house is currently vacant and suffers from lack of maintenance, but retains overall architectural integrity. Atwood, a real estate agent with an office at 72 Winter Street, had inherited a fortune in rental real estate from his father. He had previously lived at his father's house at 1 Bridgham Street (demolished) before building this opulent home for himself. In 1901 he advertized in the Providence Directory as offering the following services: real estate, tenants to let, auctioneer, mortgage and insurance broker, and state agent for Tuttle's Horse and Family Elixir. On the same lot is a NC, c. 1950, 1-story, concrete-block structure, with a glass-and-aluminum storefront with pink and blue spandrel panels.
- 576 Robert E. Smith House (1898) George Cady, Architect: A 2½-story Queen Anne house with L shaped veranda; Colonial Revival, sidelighted entrances on Broad Street and Harvard Avenue facades, as well as at second story level entering onto porch roof. The house is currently vacant, though renovation is underway. Smith, owner of Robert E. Smith and Co., dealers in coal and wood, built this large two family house for himself. At the same time he constructed houses on the adjacent properties at 586 Broad Street (demolished) and 60-62 Harvard and 54-56 Harvard Avenue.

HARVARD AVENUE

- 39-41 William Halton House (1875): A 2½-story, slate-mansard-roof double house with elaborate carpentry at the double porch and window trim. Projecting, squared 2-story window bays are a later addition. Halton was a dry-goods merchant at 214 High Street.

(See Continuation Sheet #2)

United States Department of the Interior
National Park Service

National Register of Historic Places
Inventory—Nomination Form

For NPS use only

received

date entered

Continuation sheet 2

Item number 7

Page 2

Harvard Avenue (cont.)

He was living here in 1895 and renting to George A. Wall, gold plater.

- 54-56 Edwin and Sarah Burnham House (1898): A 2½-story Queen Anne with two-story bay window and porch on main facade. The structure is clapboarded with cut shingles in the gable-peak. This building was built by Robert E. Smith and sold after construction to Edwin B. Burnham, who died in September, 1898, leaving a widow, Sarah, who continued to live in the house for many years.
- NC-57 Charles H. George House (1875): Once an imposing, asymmetrical, 2½-story slate-mansard-roof house notable for its elaborate detailing. Of particular interest is the Queen Anne spindlework gazebo-like side porch added at a later date. The house has suffered a serious fire and has been partially demolished. George was a partner in Charles H. George & Co., hardware dealers at 43 Weybosset Street.
- 57 rear Charles H. George Carriage House (1875): A fine, 1½-story, asymmetrical slate-mansard-roof carriage house, echoing in simple fashion the main house on the property. The building has been converted to a garage.
- 60-62 Robert E. Smith Rental (1898), E.A. Paris, builder: A 2½-story Queen Anne, two family house with 2-story bay window and porch on main facade. The building is nicely detailed with particular attention to the gable-end where the two third-story windows have an elaborate entablature and a center panel with applied decoration. This building was built by Robert Smith as a rental property.

United States Department of the Interior
National Park Service

National Register of Historic Places Inventory—Nomination Form

For NPS use only

received

date entered

Continuation sheet 3

Item number 10

Page 2

The boundary begins at the northwest corner of Plat 45, lot 831, runs east along the north bounds of lots 831, 20, 21, and 23, south along the east bound of lot 23, west along the south bounds of lots 23 and 22, south, across Harvard Avenue and along the east bound of lot 216, west along the south bound of lots 216, 786, and 67, then north along the west bounds of lots 67, 17, and 831, to the point of beginning. Included are lots 17, 20, 22, 23, 67, 216, 786, and 831.

This boundary encompasses the resource and its immediate setting. It includes the land historically and currently associated with the structures.

8. Significance

Period	Areas of Significance—Check and justify below			
<input type="checkbox"/> prehistoric	<input type="checkbox"/> archeology-prehistoric	<input type="checkbox"/> community planning	<input type="checkbox"/> landscape architecture	<input type="checkbox"/> religion
<input type="checkbox"/> 1400-1499	<input type="checkbox"/> archeology-historic	<input type="checkbox"/> conservation	<input type="checkbox"/> law	<input type="checkbox"/> science
<input type="checkbox"/> 1500-1599	<input type="checkbox"/> agriculture	<input type="checkbox"/> economics	<input type="checkbox"/> literature	<input type="checkbox"/> sculpture
<input type="checkbox"/> 1600-1699	<input checked="" type="checkbox"/> architecture	<input type="checkbox"/> education	<input type="checkbox"/> military	<input type="checkbox"/> social/ humanitarian
<input type="checkbox"/> 1700-1799	<input type="checkbox"/> art	<input type="checkbox"/> engineering	<input type="checkbox"/> music	<input type="checkbox"/> theater
<input checked="" type="checkbox"/> 1800-1899	<input type="checkbox"/> commerce	<input type="checkbox"/> exploration/settlement	<input type="checkbox"/> philosophy	<input type="checkbox"/> transportation
<input type="checkbox"/> 1900-	<input type="checkbox"/> communications	<input type="checkbox"/> industry	<input type="checkbox"/> politics/government	<input type="checkbox"/> other (specify)
		<input type="checkbox"/> invention		

Specific dates see inventory **Builder/Architect** see inventory

Statement of Significance (in one paragraph)

This proposed amendment represents the general areas and periods of significance documented by the Parkis-Comstock Historic District. It is a notable, urban, upper class, residential enclave, and it contains additional examples of the substantial and elaborate Second Empire and Queen Anne residences constructed by prosperous Providence merchants and businessmen in the post-Civil War era.

United States Department of the Interior
National Park Service

National Register of Historic Places
Inventory—Nomination Form

For NPS use only

received

date entered

Continuation sheet. 1

Item number 6

Page 2

Woodward, Wm., McKenzie and Edward F. Sanderson, Providence: A Citywide
Survey of Historic Resources, Rhode Island Historical Preservation
Commission, Providence, 1986.

9. Major Bibliographical References

Woodward, Wm. McKenzie and Edward F. Sanderson
1986 Providence: A Citywide Survey of Historic Resources
Rhode Island Historical Preservation Commission

10. Geographical Data

Acree of nominated property c. 1 acre

Quadrangle name Providence

Quadrangle scale 1:24,000

UTM References

A

1	9	2	9	8	8	9	0	4	6	3	1	1	4	0
Zone		Easting				Northing								

B

Zone		Easting				Northing								

C

Zone		Easting				Northing								

D

Zone		Easting				Northing								

E

Zone		Easting				Northing								

F

Zone		Easting				Northing								

G

Zone		Easting				Northing								

H

Zone		Easting				Northing								

Verbal boundary description and justification

(See Continuation Sheet #3)

List all states and counties for properties overlapping state or county boundaries

state	code	county	code

11. Form Prepared By

name/title Virginia A. Fitch

organization Public Archaeology Lab date February, 1988

street & number 287 Lonsdale Avenue telephone 401-728-8780

city or town Pawtucket state Rhode Island 02960

12. State Historic Preservation Officer Certification

The evaluated significance of this property within the state is:

national state local

As the designated State Historic Preservation Officer for the National Historic Preservation Act of 1966 (Public Law 89-665), I hereby nominate this property for inclusion in the National Register and certify that it has been evaluated according to the criteria and procedures set forth by the National Park Service.

State Historic Preservation Officer signature _____

title _____ date _____

For NPS use only:
I hereby certify that this property is included in the National Register
_____ date _____

Keeper of the National Register _____

Attest: _____ date _____

Chief of Registration _____



PARKIS-COMSTOCK HISTORIC DISTRICT, AMENDMENT
Providence, Rhode Island

Photographer: Clark Schoettle

Date: February, 1988

Negative: Providence Preservation Society
24 Meeting Street
Providence, Rhode Island

View: 39-41 Harvard Avenue, south elevation.

Photo #5



PARKIS-COMSTOCK HISTORIC DISTRICT, AMENDMENT
Providence, Rhode Island

Photographer: Clark Schoettle

Date: February, 1988

Negative: Providence Preservation Society

View: 57 (left) and 39-41 (right) Harvard Avenue,
south and west elevations.

Photo #3



PARKIS-COMSTOCK HISTORIC DISTRICT, AMENDMENT
Providence, Rhode Island

Photographer: Clark Schoettle

Date: February 1988

Negative: Providence Preservation Society
24 Meeting Street
Providence, RI

View: 570-572 Broad Street, south elevation;
57 Harvard Avenue on right (before fire).

Photo #2



PARKIS-COMSTOCK HISTORIC DISTRICT, AMENDMENT
Providence, Rhode Island

Photographer: Clark Schoettle

Date: February, 1988

Negative: Providence Preservation Society
24 Meeting Street
Providence, RI

View: 570-572 Broad Street, west elevation;
non-contributing commercial building to left.

Photo #1



PARKIS-COMSTOCK HISTORIC DISTRICT, AMENDMENT
Providence, Rhode Island

Photographer: Clark Schoettle

Date: February, 1988

Negative: Providence Preservation Society
24 Meeting Street
Providence, Rhode Island

View: 576 Broad Street and 60-62 Harvard Avenue,
north and west elevations.

Photo #6



PARKIS-COMSTOCK HISTORIC DISTRICT, AMENDMENT
Providence, Rhode Island

Photographer: Clark Schoettle

Date: February, 1988

Negative: Providence Preservation Society
24 Meeting Street
Providence, Rhode Island

View: 54-56 (left) and 60-62 Harvard Avenue,
north elevations.

Photo #7



PARKIS-COMSTOCK HISTORIC DISTRICT, AMENDMENT
Providence, Rhode Island

Photographer: Clark Schoettle

Date: February, 1988

Negative: Providence Preservation Society
24 Meeting Street
Providence, Rhode Island

View: Carriage house, 57 Harvard Avenue.

Photo #4



PROVIDENCE

PARKIS-COMSTOCK HISTORIC DISTRICT AMENDMENT

A 19 298890 4631140



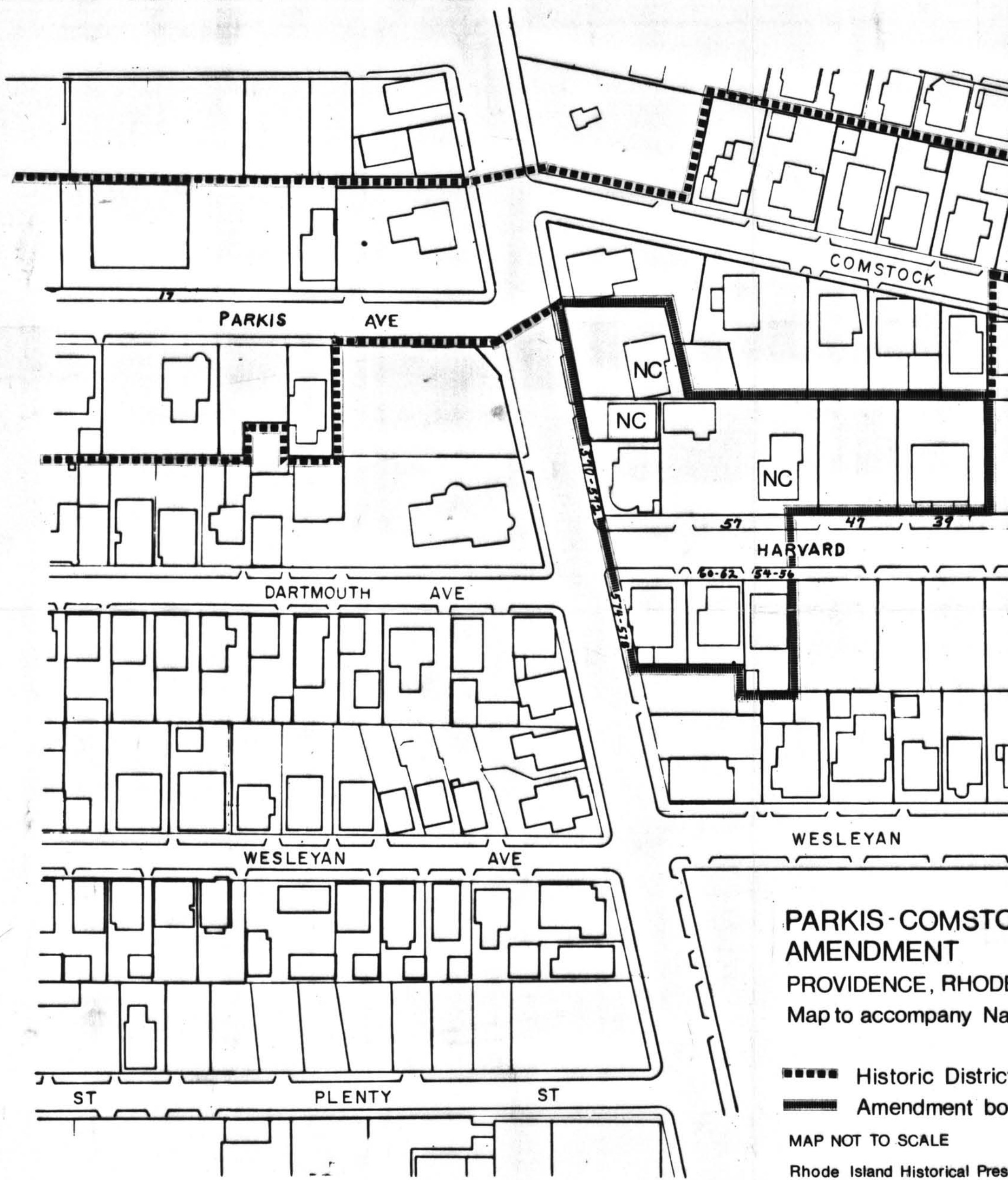

**PARKIS-COMSTOCK
AMENDMENT**
PROVIDENCE, RHODE ISLAND
Map to accompany National Historic Register

- Historic District Boundary
- Amendment Boundary

MAP NOT TO SCALE
Rhode Island Historical Preservation Society

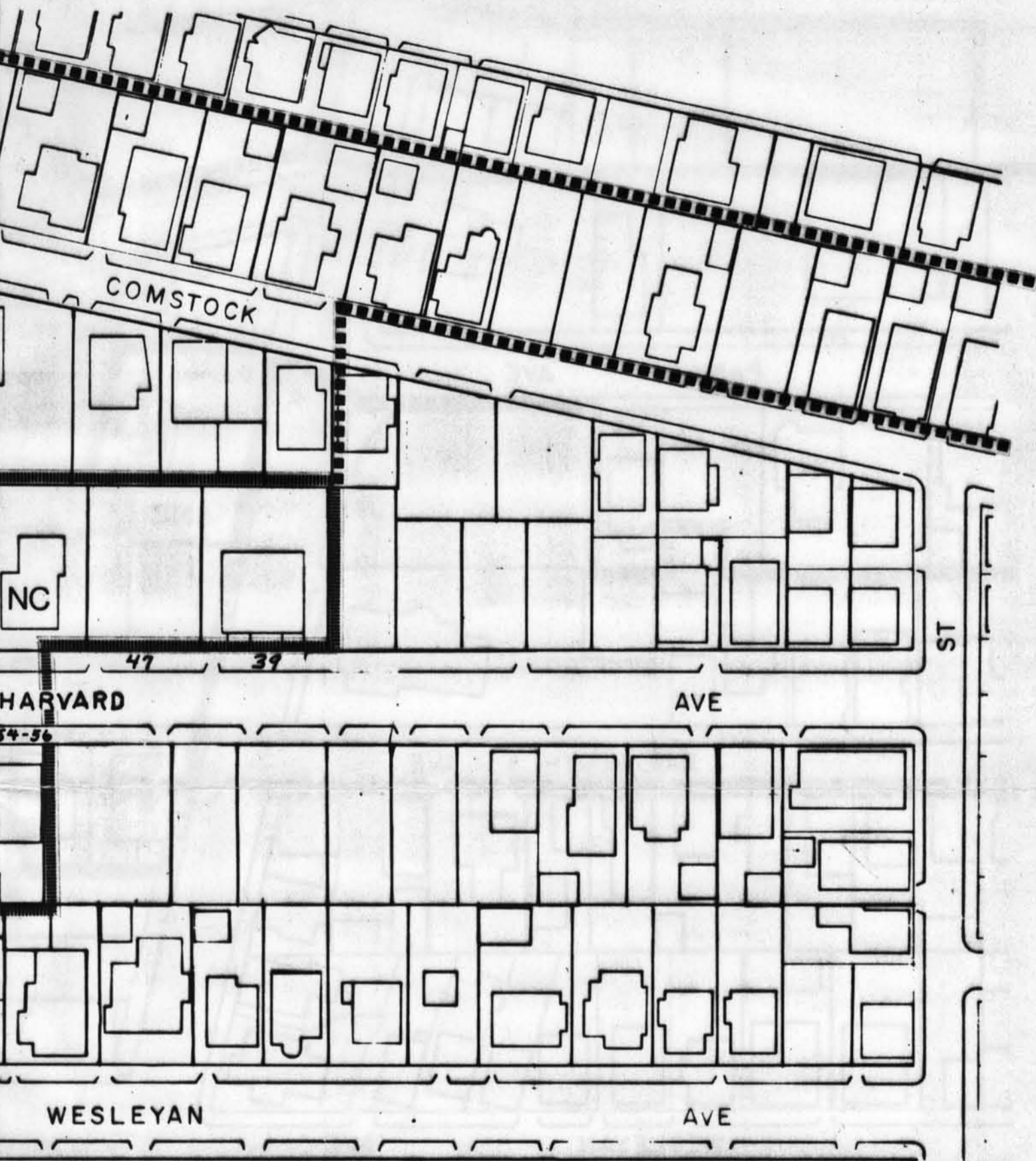

PARKIS-COMSTOCK HISTORIC DISTRICT AMENDMENT

PROVIDENCE, RHODE ISLAND

Map to accompany National Register nomination form

- Historic District boundary
- Amendment boundary

MAP NOT TO SCALE



Rhode Island Historical Preservation Commission - March 1988